

## SET UP INSTRUCTIONS

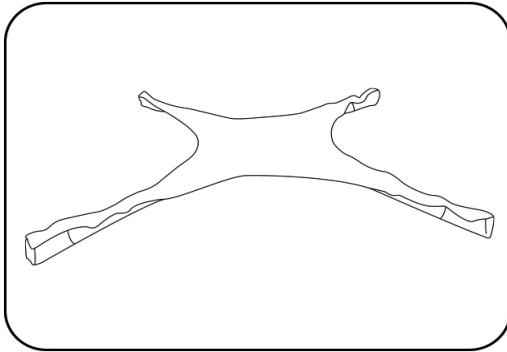

1. LAY TENT FLAT OUT ON THE GROUND

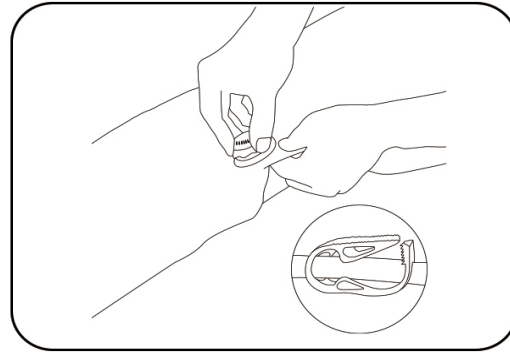

2. MAKE SURE BOTTOM VALVES ARE TIGHTENED AND OPEN TOP INLET VALVE

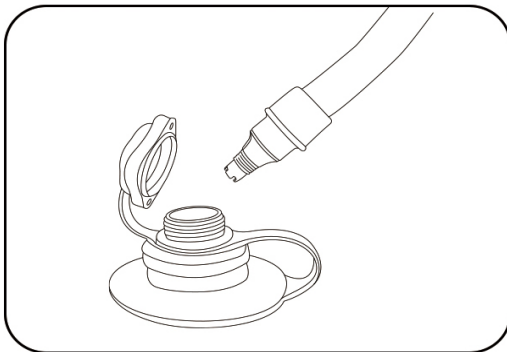

3. INSERT AIR PUMP HOSE INTO INPUT VALVE ON TENT LEG AND POWER PUMP ON TO INFLATE. MAKE SURE TO STRAIGHTEN OUT TENT LEGS AND SUPPORT TENT DURING INFLATION.

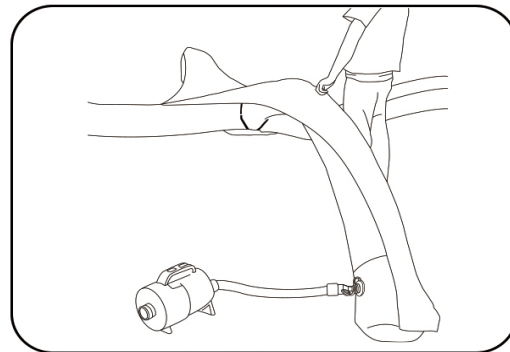

4. ONCE FULLY INFLATED CLOSE THE INPUT VALVE COVER. REPEAT STEPS FOR ALL 4 TENT LEGS TO COMPLETE INFLATION.

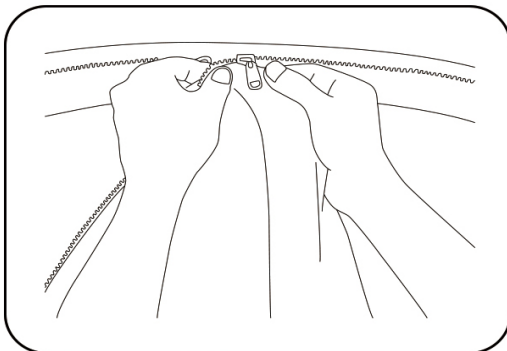

**\*OPTIONAL WALL INSTALLATION\***  
ALIGN ZIPPERS ON WALL OR AWNING WITH ZIPPERS ON TENT OPENINGS AND ZIP CLOSE TO ATTACH. THERE ARE 2 ZIPPERS PER PANEL. ZIP UPWARDS FROM THE BOTTOM OF EACH LEG TO THE MIDDLE OF THE OPENING

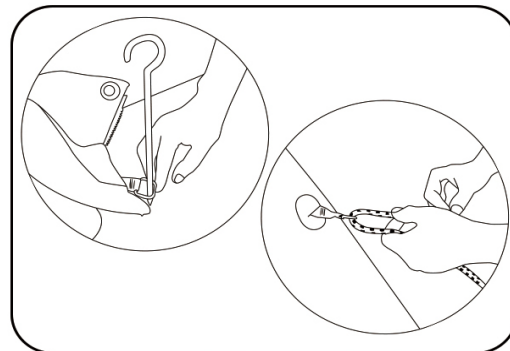

**\*ROPE AND STAKE INSTALLATION\***  
TETHER ONE END OF THE ROPE TO LOOPS OR D RINGS RINGS ON TENT LEGS AND THE OTHER END TO THE STAKE. INSERT STAKE INTO GROUND MAKING SURE THERE IS ADEQUATE TENSION ON THE ROPE. SEE NEXT PAGE FOR INSTALLATION VISUAL

## ROPE & STAKE/SANDBAG INSTALLATION

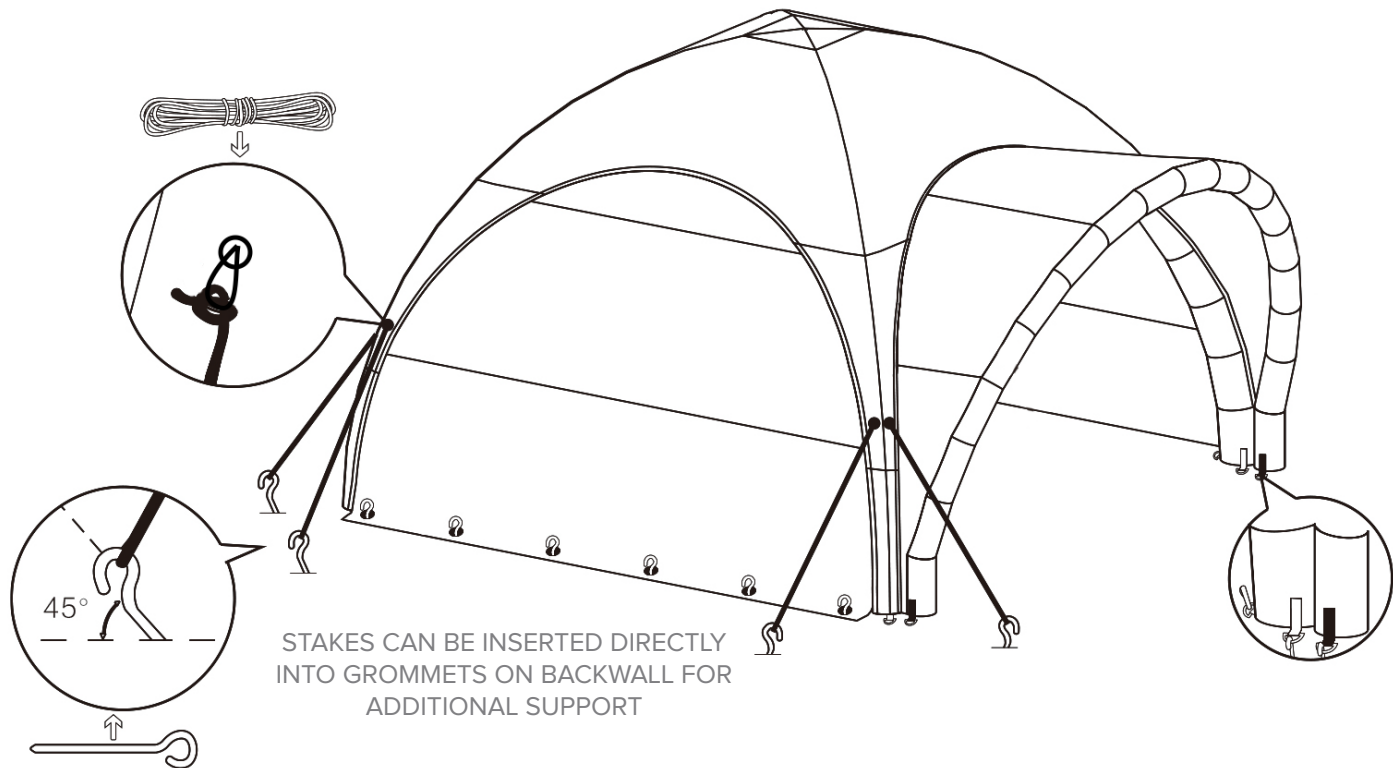

DIRECT STAKE INSTALLATION

SAND BAG INSTALLATION

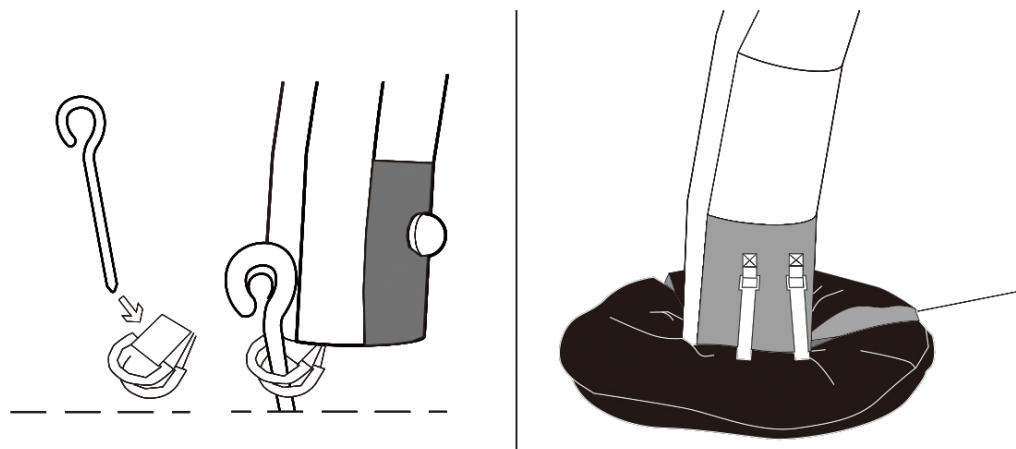

## AERIAL VIEW

